

\$9,500,000 - Township Road 240, Rural Wheatland County

MLS® #A2204172

\$9,500,000

0 Bedroom, 0.00 Bathroom,
Commercial on 0.00 Acres

NONE, Rural Wheatland County, Alberta

all set up to run your business from,,,,,10 acres with 44,000 sq.ft of office space/shop/class rooms.... main office / shop is about 14,700 sq.ft/ 2nd building is 23,000 sq.ft....

multi

purpose.use.....office....storage...manufacturing ...logistics.....church...school...very well maintained...

Built in 2013

Essential Information

MLS® #	A2204172
Price	\$9,500,000
Bathrooms	0.00
Acres	0.00
Year Built	2013
Type	Commercial
Sub-Type	Mixed Use
Status	Active

Community Information

Address	Township Road 240
Subdivision	NONE
City	Rural Wheatland County
County	Wheatland County
Province	Alberta
Postal Code	T1P 0R5

Additional Information

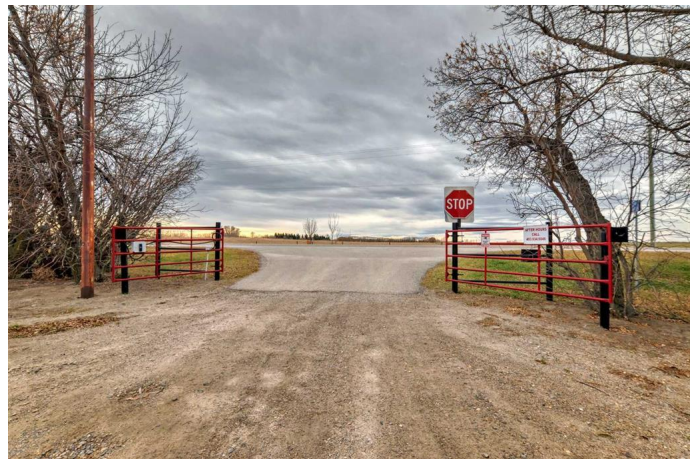

Date Listed March 25th, 2025

Days on Market 28

Zoning Direct Control

Listing Details

Listing Office CIR Realty

Data is supplied by Pillar 9â,,ç MLSÂ® System. Pillar 9â,,ç is the owner of the copyright in its MLSÂ® System. Data is deemed reliable but is not guaranteed accurate by Pillar 9â,,ç. The trademarks MLSÂ®, Multiple Listing ServiceÂ® and the associated logos are owned by The Canadian Real Estate Association (CREA) and identify the quality of services provided by real estate professionals who are members of CREA. Used under license.