

# \$325,000 - 7960 Creekside Drive, Rural Grande Prairie No. 1, County of

MLS® #A2048915

**\$325,000**

0 Bedroom, 0.00 Bathroom,  
Land on 0.87 Acres

Taylor Estates, Rural Grande Prairie No. 1,  
County of, Alberta

Taylor Estates, the most sought after address in the Peace; Taylor Estates affords you all of the convenience of city living and all the comfort of country life in this well-planned community. On the Southwest edge of the city, in the County of Grande Prairie, large rural estate properties are situated on the banks of Bear Creek. Choose your lot, choose your builder, and get started on your Dream Home in Taylor Estates.

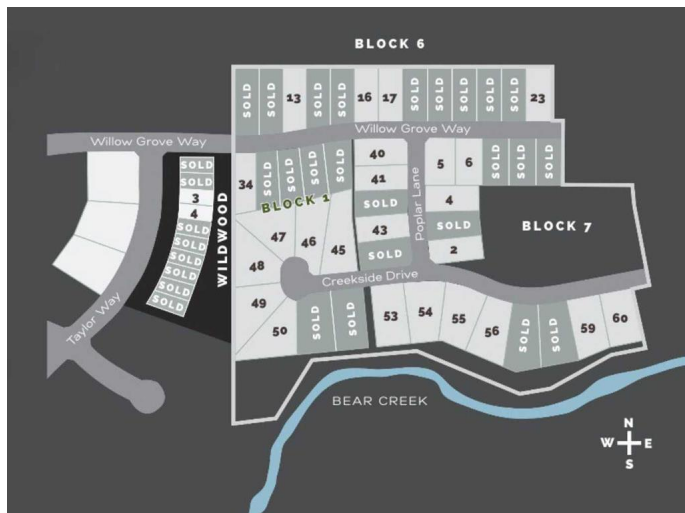

## Essential Information

MLS® #	A2048915
Price	\$325,000
Bathrooms	0.00
Acres	0.87
Type	Land
Sub-Type	Residential Land
Status	Active

## Community Information

Address	7960 Creekside Drive
Subdivision	Taylor Estates
City	Rural Grande Prairie No. 1, C
County	Grande Prairie No. 1, County of
Province	Alberta
Postal Code	T8W 0H3



## Amenities

Utilities Cable Available, Electricity Available, Natural Gas Available, Phone Available

## Additional Information

Date Listed May 23rd, 2023

Days on Market 682

Zoning RE

## Listing Details

Listing Office RE/MAX Grande Prairie

Data is supplied by Pillar 9â„¢ MLSÂ® System. Pillar 9â„¢ is the owner of the copyright in its MLSÂ® System. Data is deemed reliable but is not guaranteed accurate by Pillar 9â„¢. The trademarks MLSÂ®, Multiple Listing ServiceÂ® and the associated logos are owned by The Canadian Real Estate Association (CREA) and identify the quality of services provided by real estate professionals who are members of CREA. Used under license.