

\$50,000 - 281 Mabbott Road, Drumheller

MLS® #A2005289

\$50,000

0 Bedroom, 0.00 Bathroom,
Land on 0.48 Acres

Rosedale, Drumheller, Alberta

This almost half acre parcel is located in the subdivision of Rosedale across from the old 3 par golf course. Lot is 20,886 ft.Â². Municipal Water line runs on the opposite side of the road and would need septic system as municipal sewage stops at the top of the hillâ€"no known time frames to build here, STANDATA applies to any building, this bareland lot is in the neighborhood of StarMine in the town of Drumheller.

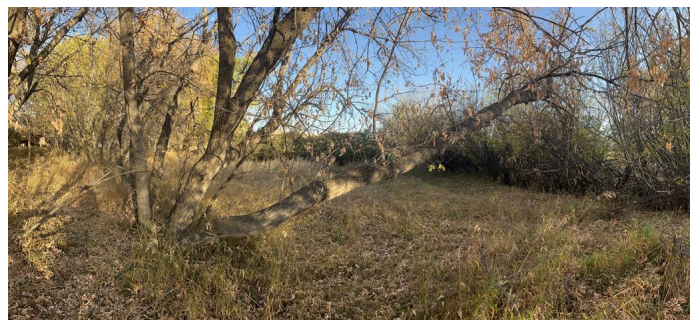
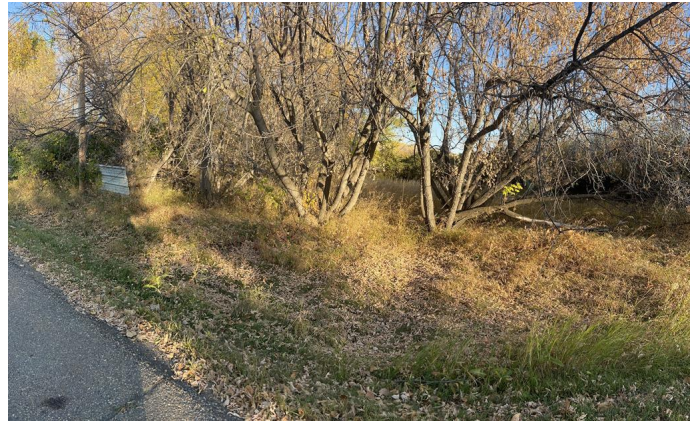

Essential Information

MLS® #	A2005289
Price	\$50,000
Bathrooms	0.00
Acres	0.48
Type	Land
Sub-Type	Residential Land
Status	Active

Community Information

Address	281 Mabbott Road
Subdivision	Rosedale
City	Drumheller
County	Drumheller
Province	Alberta
Postal Code	T0J 0Y9

Exterior

Lot Description	Cleared, Flood Plain, Level
-----------------	-----------------------------

Additional Information

Date Listed	October 7th, 2022
Days on Market	906
Zoning	CSD

Listing Details

Listing Office	Century 21 Masters
----------------	--------------------

Data is supplied by Pillar 9â„¸ MLSÂ® System. Pillar 9â„¸ is the owner of the copyright in its MLSÂ® System. Data is deemed reliable but is not guaranteed accurate by Pillar 9â„¸. The trademarks MLSÂ®, Multiple Listing ServiceÂ® and the associated logos are owned by The Canadian Real Estate Association (CREA) and identify the quality of services provided by real estate professionals who are members of CREA. Used under license.