

# \$42,750 - 23 Bear Creek Drive, High Level

MLS® #A1027876

**\$42,750**

0 Bedroom, 0.00 Bathroom,  
Land on 0.12 Acres

NONE, High Level, Alberta

There are so many reasons why this may be the perfect location for your new home.

LOCATION, LOCATION, LOCATION!!!

Close to the hospital, shopping, the Toy Lending Library and then there's the price? This neighborhood is zoned R-2 which means manufactured and modular homes, an economical alternative to stick built homes, are permitted uses. DEVELOPERS?? An awesome location to build revenue properties.

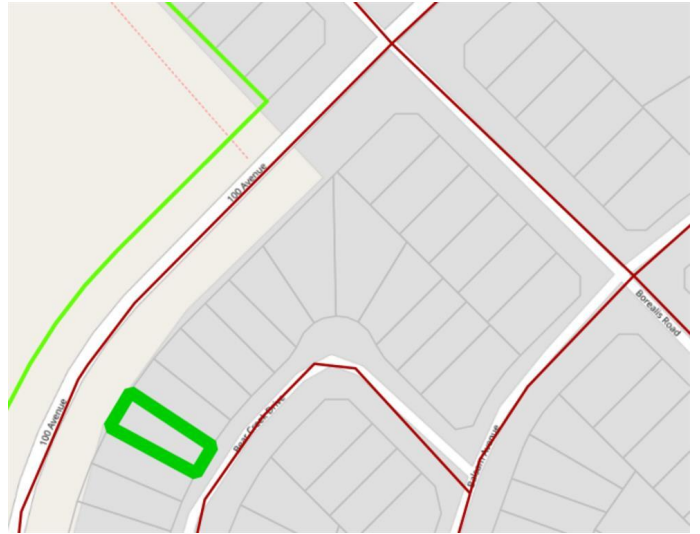

## Essential Information

|           |          |
|-----------|----------|
| MLS® #    | A1027876 |
| Price     | \$42,750 |
| Bathrooms | 0.00     |
| Acres     | 0.12     |
| Type      | Land     |
| Sub-Type  | Land     |
| Status    | Active   |

## Community Information

|             |                     |
|-------------|---------------------|
| Address     | 23 Bear Creek Drive |
| Subdivision | NONE                |
| City        | High Level          |
| County      | Mackenzie County    |
| Province    | Alberta             |
| Postal Code | T0H 1Z0             |

## Amenities

|           |  |
|-----------|--|
| Utilities | Electricity at Lot Line, Natural Gas at Lot Line |
|-----------|--|

## Additional Information

|                |                   |
|----------------|-------------------|
| Date Listed    | August 27th, 2020 |
| Days on Market | 1642              |
| Zoning         | Residential       |

## Listing Details

|                |                                     |
|----------------|-------------------------------------|
| Listing Office | Century 21 Prime Realty (2002) Ltd. |
|----------------|-------------------------------------|

Data is supplied by Pillar 9â„¢ MLS® System. Pillar 9â„¢ is the owner of the copyright in its MLS® System. Data is deemed reliable but is not guaranteed accurate by Pillar 9â„¢. The trademarks MLS®, Multiple Listing Service® and the associated logos are owned by The Canadian Real Estate Association (CREA) and identify the quality of services provided by real estate professionals who are members of CREA. Used under license.